

HEAVY DUTY & WATER RESISTANT Flush Floor Box

Round, Stainless Steel

AT A GLANCE...

- Water Resistant: IP44 Rating
- Slip Resistant: P3 Rating
- Load Rating: Suits vehicle traffic – see chart over
- Capacity: 2 No. IP66 Industrial socket modules
- Box Size: 298mm dia. x 150mm deep
- Lid Material: Stainless 304 – 36 Grit Linished
- Features: **Cable Shield®** Frame

- Ideal for use in shopping centres.
- Heavy duty – load rated floor box suitable for vehicular traffic.
- Round, hinged lid with 2 x neoprene gaskets (for water resistance when lid is in closed position – IP44).
Note: Not suited for external use.
- Protector™ Series features
 - **Cable Shield®** Frame assembly to prevent cables being cut. (Patent Certified 2019268210 & 2015204344)
- Lockable with 2 keys/lifting tools supplied.
- Frame has square edges (not bevelled) to allow flush fitting to adjacent floor finish (typically timber, tiles or vinyl).
- 304 Grade solid stainless steel lid with 36 Grit Linished finish to meet P3 requirements for slip resistance in public spaces (wet areas or supermarket/shopping centres).
- Capacity for 2 No. IP66 Industrial socket modules.
- Supplied with temporary construction lid.
- This product has been examined in accordance with AS 3000 and conforms to A.C.M.A. requirements.

“Easy as ECD®”



ESTABLISHED 1979

Electric Cable Duct Systems P/L

Phone: 1300 123 ECD (323)

Email: info@ecd.net.au

Fax: 1300 372 825

website: www.ecd.net.au

ABN 80005544105

ASSEMBLY DIAGRAM

HEAVY DUTY AND WATER RESISTANT FLUSH FLOOR BOX – ROUND, STAINLESS STEEL – FBIPW56

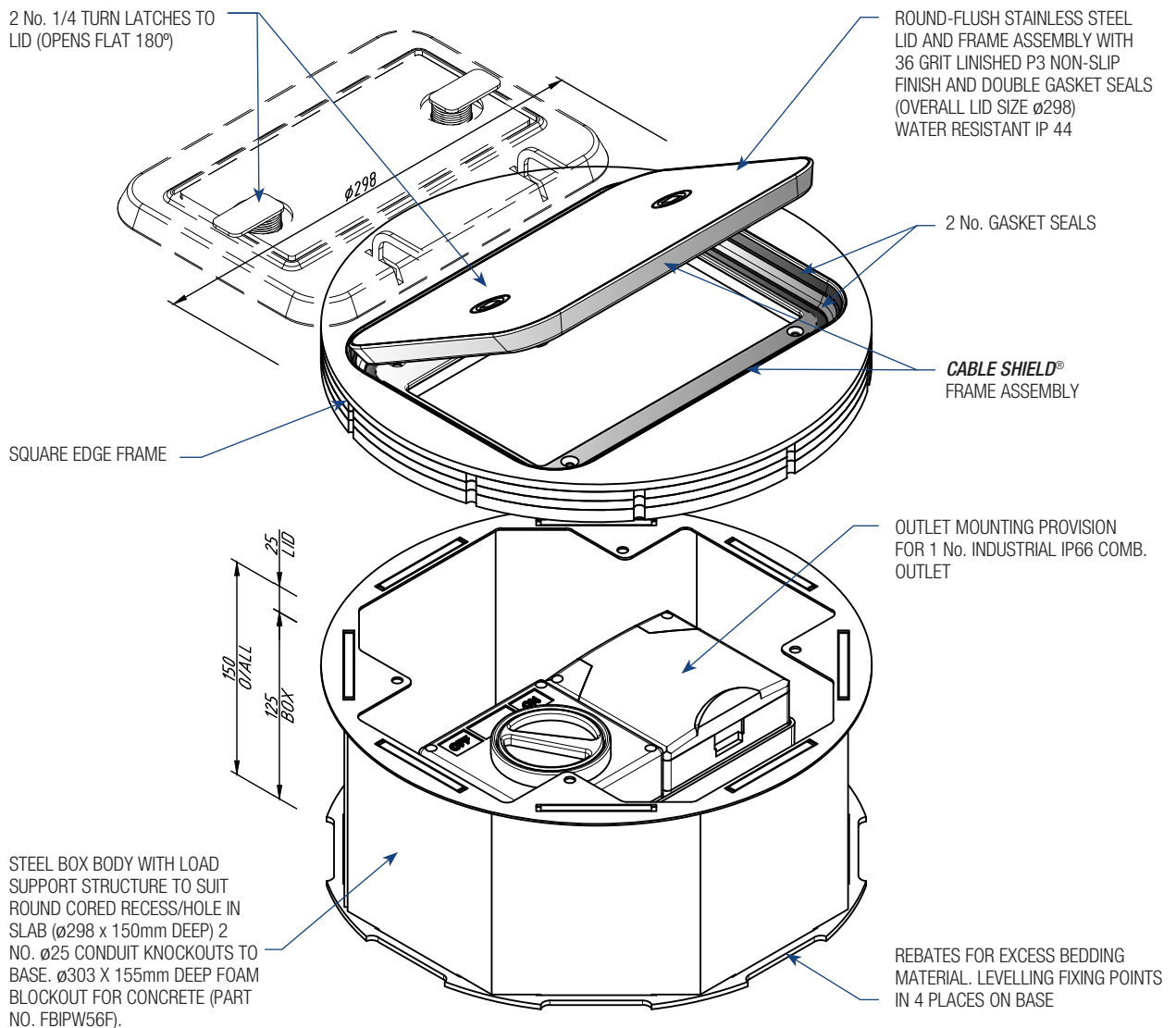

OUTLET MOUNTING PROVISION FOR 1 No. INDUSTRIAL IP66 COMB. OUTLET

LID IN OPEN FLAT POSITION

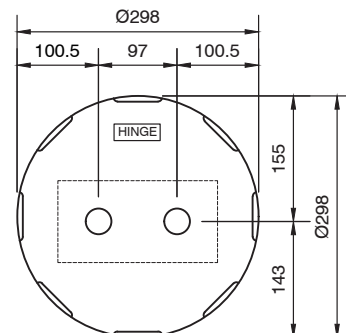
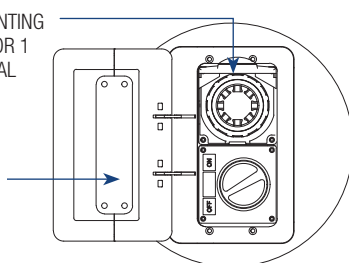

PLAN VIEW OF BOX

CONDUIT LOCATION BOX BASE

POINT LOAD TABLE	
LOAD TYPE	MAX LOAD
25 X 25 PT. LOAD	1,400kg
150 X 60 WHEEL	1,550kg
TOTAL VEHICLE (1550kg x 4 wheels)	6,200kg

NOM. CAR KERB WEIGHT 1800KG

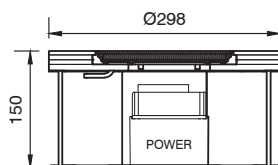

SECTION THRU' BOX

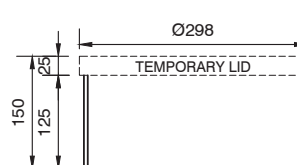

CONDUIT LOCATION SIDES
(NOTE: NO CONDUIT LOCATION ON SIDES)