

**Flush Floor Box** Deep Recessed, Stainless Steel, Soft Close**AT A GLANCE...**

- Capacity: 6 x single auto switched power outlets and 8 x data mounts
- Box Size: 370 x 250 x 93 mm
- Lid Material: Stainless 304 – No. 4 Linished
- Lid Recess: 20 mm Deep
- Suitable for: Cat6A and Cat7A Cabling

**“Easy as ECD®”**

- Recessed Stainless Steel Lid and Frame with 20mm rebate for floor finish (typically polished timber boards or ceramic tiles).
- 304 Grade solid Stainless Steel lid construction with No. 4 Linished finish.
- Gas Strut Assistance to control lid closure – suits floor finish infills up to 1.2kg (eg. timber packer & carpet or full timber).
- Additional Gas Strut kit available to suit heavier floor finish infills from 2kg (eg. ceramic tile) up to 5kg (eg. stone). Custom heavier Gas Strut kits available to order.
- Frame has square edges (not bevelled) to allow flush fitting to adjacent floor finish.
- Height adjustable lid and frame.
- Robust, large capacity cable exit flap with CableShield and stainless lifting handle.
  - Option to fit cam lock if required.
  - Capacity for 6 x single auto switched power outlets (supplied) and 8 x data mounts.
  - Suitable for category 6A and 7A data cabling with generous bend radius capacity.
  - Suitable for Audio / Video outlets including VGA, HDMI, USB, etc.
  - Modular box body and lid design, interchangeable with plastic and other lids in the ECD® floor box range.



ESTABLISHED 1979

**Electric Cable Duct Systems P/L**

Phone: 1300 123 ECD (323)

Fax: 1300 372 825

Email: [info@ecd.net.au](mailto:info@ecd.net.au)website: [www.ecd.net.au](http://www.ecd.net.au)

ABN 80005544105

# ASSEMBLY DIAGRAM

## FLUSH FLOOR BOX – DEEP RECESSED, STAINLESS STEEL, SOFT CLOSE – FB6SDR70

CABLE SHIELD®  
TO CABLE EXIT  
FLAP ASSEMBLY

FB6SDR70 STAINLESS STEEL DEEP RECESSED GAS STRUT CLOSE ASSISTED LID AND FRAME ASSEMBLY WITH CABLE EXIT, RUBBER DUST SEAL AND RECESSED LIFTING HANDLE (OVERALL LID SIZE 370 x 250 x 38 DEEP) (RECESS 20mm DEEP)  
NOTE: SINGLE GAS STRUT SUITS LID INFILLS UP TO 1.2KG (EG. TIMBER PACKER & CARPET OR FULL TIMBER INFILL)

POINT LOAD TABLE	
LOAD TYPE	MAX LOAD
25 X 25 PT. LOAD	200kg
150 X 60 WHEEL	180kg

SUPPLIED AS STANDARD WITH 1 GAS STRUT. OPTIONAL SECOND GAS STRUT KIT AVAILABLE FOR HEAVY LID INFILLS (PART NO. FB4SDR-GSK) SUITS LID INFILLS FROM 2-5 KG (EG. CERAMIC TILES - STONE)  
CUSTOM GAS STRUT KITS AVAILABLE TO ORDER FOR HEAVIER INFILLS.  
LID INFILLS BETWEEN 1.2 & 2 KG WILL REQUIRE EITHER A CUSTOM WEIGHTED PACKER (RECESS DEPTH PERMITTING) TO REACH 2KG SO THE LID WILL CLOSE.

LID ADJUSTMENT  
LEGS 4 PLACES



DATA-PLATE VIEW

2 No. OUTLET MOUNTING BRACKETS WITH PROVISION FOR 4 DATA EACH (TOTAL 8 DATA)

2 No. OUTLET MOUNTING BRACKETS WITH 3 No. AUTO SWITCH GPOs (TOTAL 6 GPOs)

STEEL BOX BODY  
(360 x 240 x 93mm DEEP)  
16 No. 25ø/32ø COMBINATION CONDUIT KNOCKOUTS

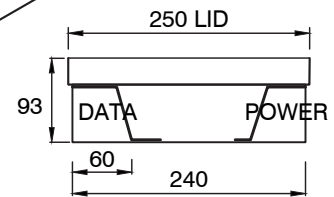

NOMINAL RECESS SIZE  
370 x 250 x 100 DEEP FOR TIMBER FLOOR OR  
400 x 300 x 100 FOAM BLOCKOUT FOR CONCRETE

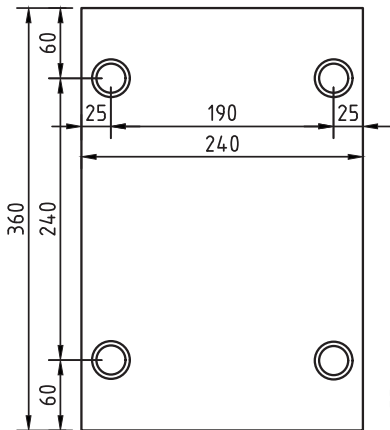

CONDUIT LOCATION  
BOX BASE

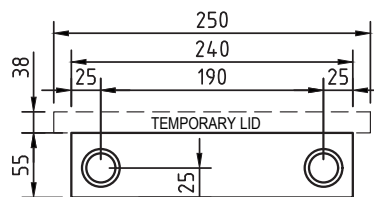

CONDUIT LOCATION  
HINGE & EXIT SIDES

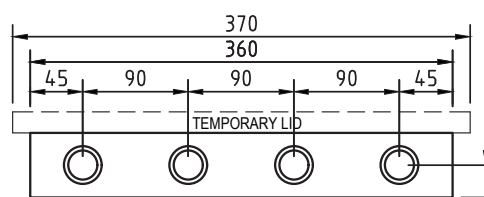

CONDUIT LOCATION  
OUTLET SIDES

27,5