

**Flush Floor Box** Deep Recessed, Stainless Steel, Soft Close**AT A GLANCE...**

- Capacity: 6 standard size plates
- Box Size: 370 x 250 x 133 mm Deep (c/w-Lid)
- Lid Material: Stainless 304 – No. 4 Linished
- Lid Recess: 20 mm Deep
- Suitable for: Cat6A and Cat7A Cabling

**“Easy as ECD®”**

- Recessed Stainless Steel lid and frame with 20mm rebate for floor finish (typically polished timber boards or ceramic tiles).
- 304 Grade solid Stainless Steel lid construction with No. 4 Linished finish.
- Gas Strut Assistance to control lid closure – suits floor finish infills up to 1.2kg (eg. timber packer & carpet or full timber).
- Additional Gas Strut kit available to suit heavier floor finish infills from 2kg (eg. ceramic tile) up to 5kg (eg. stone). Custom heavier Gas Strut kits available to order.
- Frame has square edges (not beveled) to allow flush fitting to adjacent floor finish.
- Height adjustable lid and frame.
- Robust, large capacity cable exit flap with CableShield and stainless lifting handle.
- Option to fit cam lock if required.
- Capacity for 6 standard outlet plates (3 x double power and 3 x Data and/or A.V.).
- Suitable for category 6A and 7A data cabling with generous bend radius capacity.
- Suitable for Audio / Video outlets including VGA, HDMI, USB, etc.
- Modular box body and lid design, interchangeable with plastic and other lids in the ECD® floor box range.
- Supplied with temporary construction lid.



ESTABLISHED 1979

**Electric Cable Duct Systems P/L**

Phone: 1300 123 ECD (323)

Email: [info@ecd.net.au](mailto:info@ecd.net.au)

Fax: 1300 372 825

website: [www.ecd.net.au](http://www.ecd.net.au)

ABN 80005544105

# ASSEMBLY DIAGRAM

## FLUSH FLOOR BOX – DEEP RECESSED, STAINLESS STEEL, SOFT CLOSE – FB6SDR

CABLE SHIELD®  
TO CABLE EXIT  
FLAP ASSEMBLY

SUPPLIED AS STANDARD WITH 1 GAS STRUT.  
OPTIONAL SECOND GAS STRUT KIT AVAILABLE  
FOR HEAVY LID INFILLS (PART NO. FB4SDR-GSK)  
SUITS LID INFILLS FROM 2-5 KG (EG. CERAMIC  
TILES - STONE)  
CUSTOM GAS STRUT KITS AVAILABLE TO ORDER  
FOR HEAVIER INFILLS.  
LID INFILLS BETWEEN 1.2 & 2 KG WILL REQUIRE  
EITHER A CUSTOM WEIGHTED PACKER (RECESS  
DEPTH PERMITTING) TO REACH 2KG OR A FITTED  
CAM LOCK TO HOLD THE LID CLOSED.

FB6SDR STAINLESS STEEL DEEP RECESSED  
GAS STRUT CLOSE ASSISTED LID AND FRAME  
ASSEMBLY WITH CABLE EXIT, RUBBER DUST  
SEAL AND RECESSED LIFTING HANDLE  
**(OVERALL LID SIZE 370 x 250 x 38 DEEP)**  
**(RECESS 20mm DEEP)**

NOTE: SINGLE GAS STRUT SUITS LID INFILLS UP  
TO 1.2KG (EG. TIMBER PACKER & CARPET OR  
FULL TIMBER INFILL)

| POINT LOAD TABLE |          |
|------------------|----------|
| LOAD TYPE        | MAX LOAD |
| 25 X 25 PT. LOAD | 200kg    |
| 150 X 60 WHEEL   | 180kg    |

LID ADJUSTMENT  
LEGS 4 PLACES



DATA PLATE VIEW

OUTLET MOUNTING  
BRACKET TO SUIT 3 No.  
DOUBLE GPOs

OUTLET MOUNTING  
BRACKET TO SUIT 3 No.  
STANDARD DATA GRID  
PLATES

STEEL BOX BODY  
(360 x 240 x 133mm DEEP)  
12 No. 25ø/32ø COMBINATION  
CONDUIT KNOCKOUTS

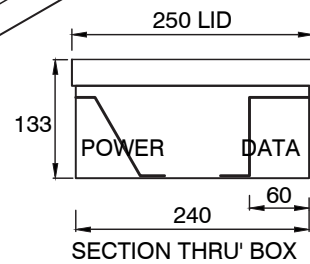

SECTION THRU' BOX

NOMINAL RECESS SIZE  
370 x 250 x 140 (NOM.) DEEP FOR TIMBER FLOOR OR  
400 x 300 x 140 FOAM BLOCKOUT FOR CONCRETE

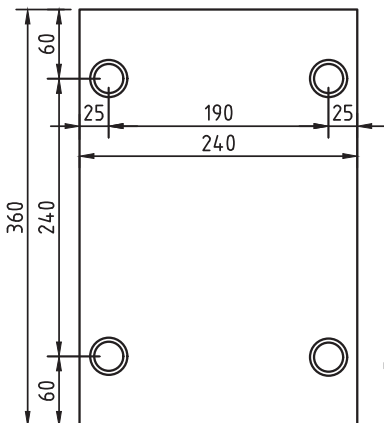

CONDUIT LOCATION  
BOX BASE

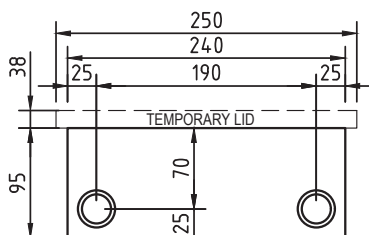

CONDUIT LOCATION  
HINGE & EXIT SIDES

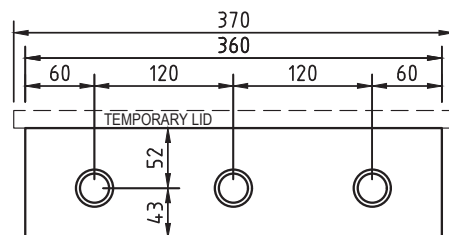

CONDUIT LOCATION  
OUTLET SIDES