

Flush Floor Box Deep Recessed, Brass, Soft Close**AT A GLANCE...**

- Capacity: 6 x single auto switched power outlets and 8 x data mounts
- Box Size: 370 x 250 x 93 mm
- Lid Material: Brass – No. 4 Linished
- Lid Recess: 20 mm Deep
- Suitable for: Cat6A and Cat7A Cabling

“Easy as ECD®”

- Recessed Brass Lid and Frame with 20mm rebate for floor finish (typically polished timber boards or ceramic tiles).
- Solid Brass lid construction with No. 4 Linished finish.
- Gas Strut Assistance to control lid closure – suits floor finish infills up to 1.2kg (eg. timber packer & carpet or full timber).
- Additional Gas Strut kit available to suit heavier floor finish infills from 2kg (eg. ceramic tile) up to 5kg (eg. stone). Custom heavier Gas Strut kits available to order.
- Frame has square edges (not bevelled) to allow flush fitting to adjacent floor finish.
- Height adjustable lid and frame.
- Robust, large capacity cable exit flap with CableShield and brass lifting handle.
 - Option to fit cam lock if required.
 - Capacity for 6 x single auto switched power outlets (supplied) and 8 x data mounts.
 - Suitable for category 6A and 7A data cabling with generous bend radius capacity.
 - Suitable for Audio / Video outlets including VGA, HDMI, USB, etc.
 - Modular box body and lid design, interchangeable with plastic and other lids in the ECD® floor box range.



ESTABLISHED 1979

Electric Cable Duct Systems P/L

Phone: 1300 123 ECD (323)

Fax: 1300 372 825

Email: info@ecd.net.auwebsite: www.ecd.net.au

ABN 80005544105

ASSEMBLY DIAGRAM

FLUSH FLOOR BOX – DEEP RECESSED, BRASS, SOFT CLOSE – FB6BDR70

CABLE SHIELD®
TO CABLE EXIT
FLAP ASSEMBLY

FB6BDR70 BRASS DEEP RECESSED GAS STRUT CLOSE ASSISTED LID AND FRAME ASSEMBLY WITH CABLE EXIT, RUBBER DUST SEAL AND RECESSED LIFTING HANDLE (OVERALL LID SIZE 370 x 250 x 38 DEEP) (RECESS 20mm DEEP)

NOTE: SINGLE GAS STRUT SUITS LID INFILLS UP TO 1.2KG (EG. TIMBER PACKER & CARPET OR FULL TIMBER INFILL)

POINT LOAD TABLE	
LOAD TYPE	MAX LOAD
25 X 25 PT. LOAD	200kg
150 X 60 WHEEL	180kg

SUPPLIED AS STANDARD WITH 1 GAS STRUT. OPTIONAL SECOND GAS STRUT KIT AVAILABLE FOR HEAVY LID INFILLS (PART NO. FB4SDR-GSK) SUITS LID INFILLS FROM 2-5 KG (EG. CERAMIC TILES - STONE) CUSTOM GAS STRUT KITS AVAILABLE TO ORDER FOR HEAVIER INFILLS. LID INFILLS BETWEEN 1.2 & 2 KG WILL REQUIRE EITHER A CUSTOM WEIGHTED PACKER (RECESS DEPTH PERMITTING) TO REACH 2KG SO THE LID WILL CLOSE.

LID ADJUSTMENT
LEGS 4 PLACES

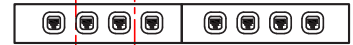

DATA-PLATE VIEW

2 No. OUTLET MOUNTING BRACKETS WITH PROVISION FOR 4 DATA EACH (TOTAL 8 DATA)

2 No. OUTLET MOUNTING BRACKETS WITH 3 No. AUTO SWITCH GPOs (TOTAL 6 GPOs)

STEEL BOX BODY
(360 x 240 x 93mm DEEP)
16 No. 25ø/32ø COMBINATION CONDUIT KNOCKOUTS

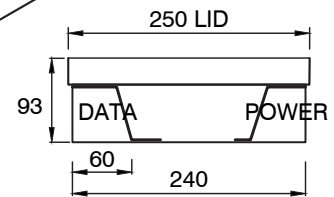

NOMINAL RECESS SIZE
370 x 250 x 100 DEEP FOR TIMBER FLOOR OR
400 x 300 x 100 FOAM BLOCKOUT FOR CONCRETE

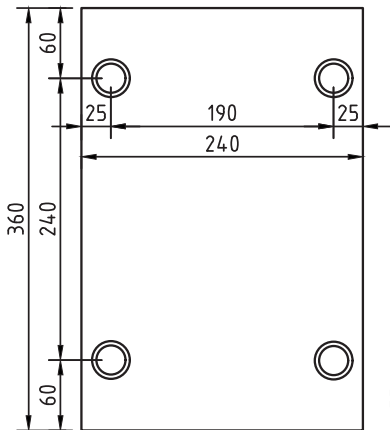

CONDUIT LOCATION
BOX BASE

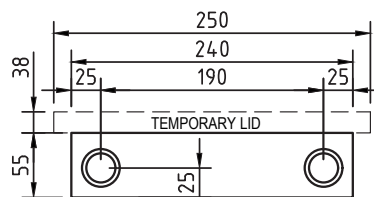

CONDUIT LOCATION
HINGE & EXIT SIDES

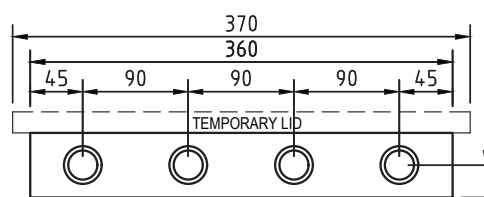

CONDUIT LOCATION
OUTLET SIDES

27,5