

Soft Wired Mounting Accessories

AT A GLANCE...

- Suitable for: Mounting of soft wired Power Modules & data
- Capacity: 2 or 4 gang Power Modules
Up to 6 x data
- Colours: Black & White

PMB



DMB

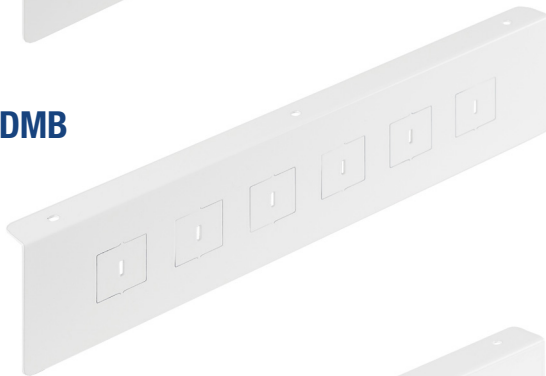

PDMB

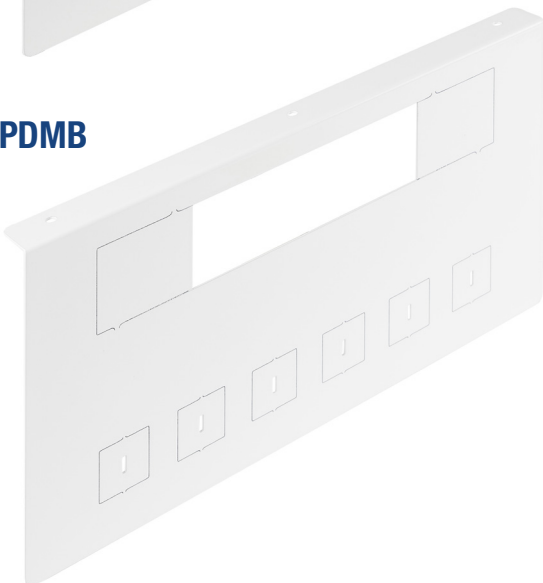

- PMB, DMB, PDMB – used to mount PM Power Modules (ECDPM2P/ECDPM4P) and/or data – typically in under desk locations.
- PMB accepts 2 gang Power Modules (ECDPM2P) in opening as supplied or 4 gang Power Modules (ECDPM4P) by removing side break off tabs to increase opening.
- DMB accepts up to 6 x data via twist out knockouts & bezels provided.
- PDMB accepts 2 or 4 gang power modules (ECDPM2P/ECDPM4P) and up to 6 x data (bezels provided).
- Can be used as stand alone or in conjunction with Wire Cable Basket (WCB) by mounting directly adjacent to the basket.
- PSMB can be used for stand alone mounting of Power Modules. Leave whole for 1 x ECDPM4P or break in half for to mount 2 x ECDPM2P.
- Compatible with the ECD Soft Wiring System.
- Standard colours are Black & White.

“Easy as ECD®”

PSMB



ESTABLISHED 1979

Electric Cable Duct Systems P/L

Phone: 1300 123 ECD (323)

Email: info@ecd.net.au

Fax: 1300 372 825

website: www.ecd.net.au

ABN 80005544105

ASSEMBLY DIAGRAM

SOFT WIRED MOUNTING ACCESSORIES

PMB

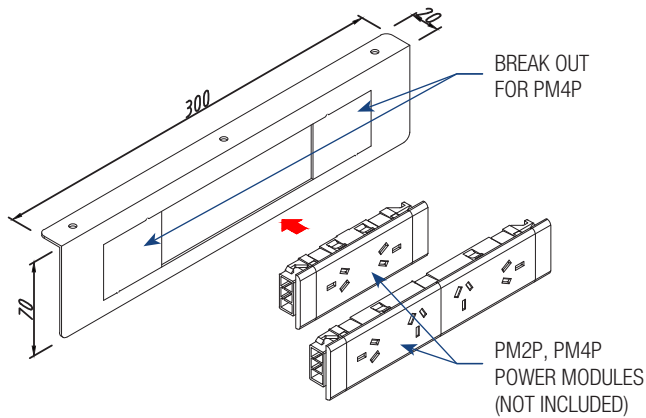

DMB

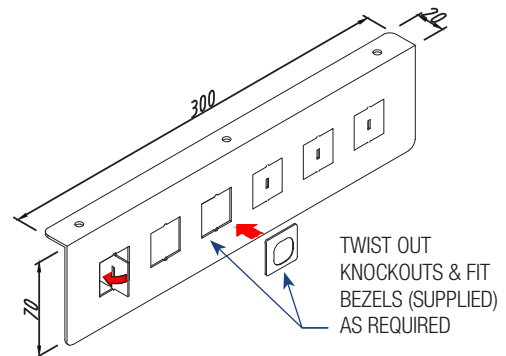

PDMB

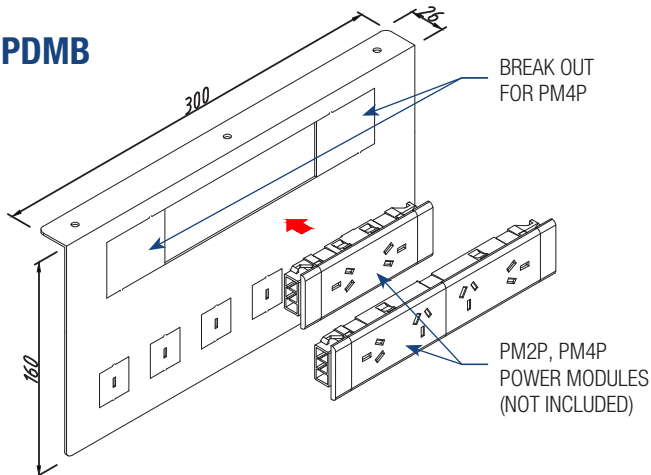

PDMB

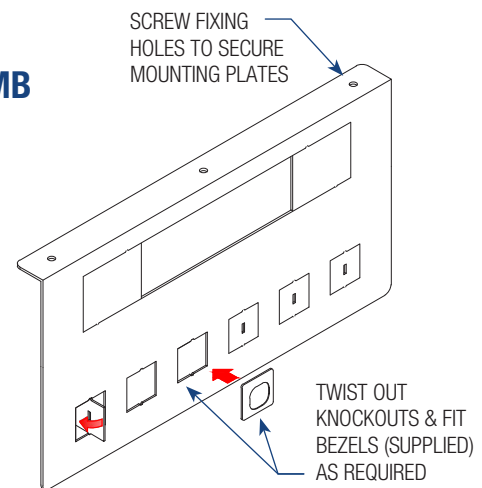

PSMB

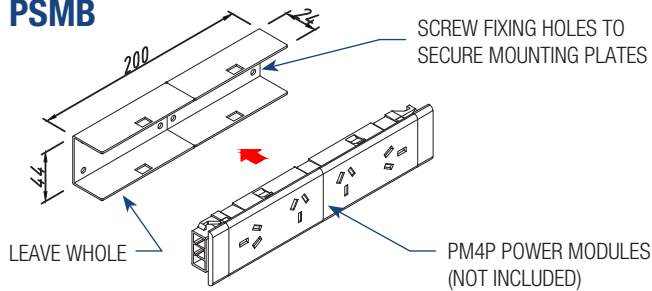

PSMB

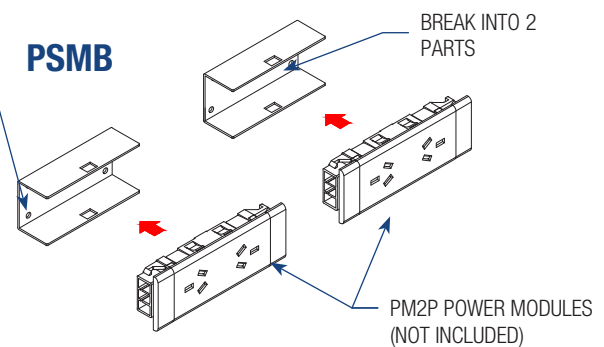

PARTS LIST

DESCRIPTION	PART NO.	COLOUR
Under Desk Mounting Bracket suits 2 or 4 gang Power Modules	PMB	Nominate (see below)
Under Desk Mounting Bracket suits up to 6 x data	DMB	Nominate (see below)
Under Desk Mounting Bracket suits 2 or 4 gang Power Modules & up to 6 x data	PDMB	Nominate (see below)
Surface Mount Bracket suits 2 x 2 or 1 x 4 gang Power Module	PSMB	Nominate (see below)

Nominate Colour/Finish: BK=Black, WE=White

Note: All ECD soft wiring must be installed by a licenced electrical contractor as per AS/NZ300 Wiring Regulations