

ECD® 'Elite Series' Skirting Duct

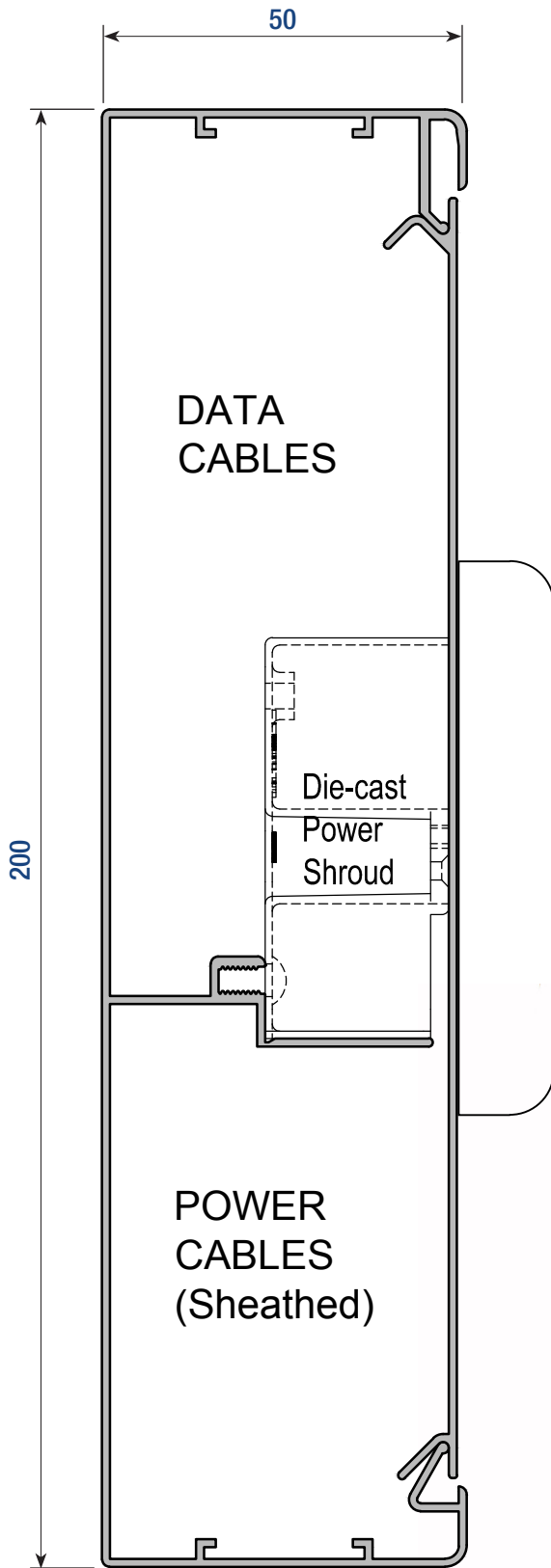

FULL SIZE SECTION

AT A GLANCE...

- Size: 200 x 50 mm
- Stock Colours: Grey, Black, White & Natural Anodised
- Suitable for: Category 6 & 6A Cabling
- Cable Capacity: See chart over leaf

- Suitable for categories 6 and 6A data cabling.
- Clip In cover (also available with "Drop In" cover).
- Extruded aluminium body.
- All outlets centrally mounted (suits power packs).
- Die-cast power shroud (easy fitting).
- Spacious data "fit-off" zone.
- Die-cast external/internal bends.
- Conforms to AS 3000 and A.C.M.A. requirements.
- Non standard powdercoat colours available.
- Bend radius available.
- Optional divider (2 or 3 division).
- Fully or semi recessed trims available.

"Easy as ECD®"



ESTABLISHED 1979

Electric Cable Duct Systems P/L

Phone: 1300 123 ECD (323)

Email: info@ecd.net.au

Fax: 1300 372 825

website: www.ecd.net.au

ABN 80005544105

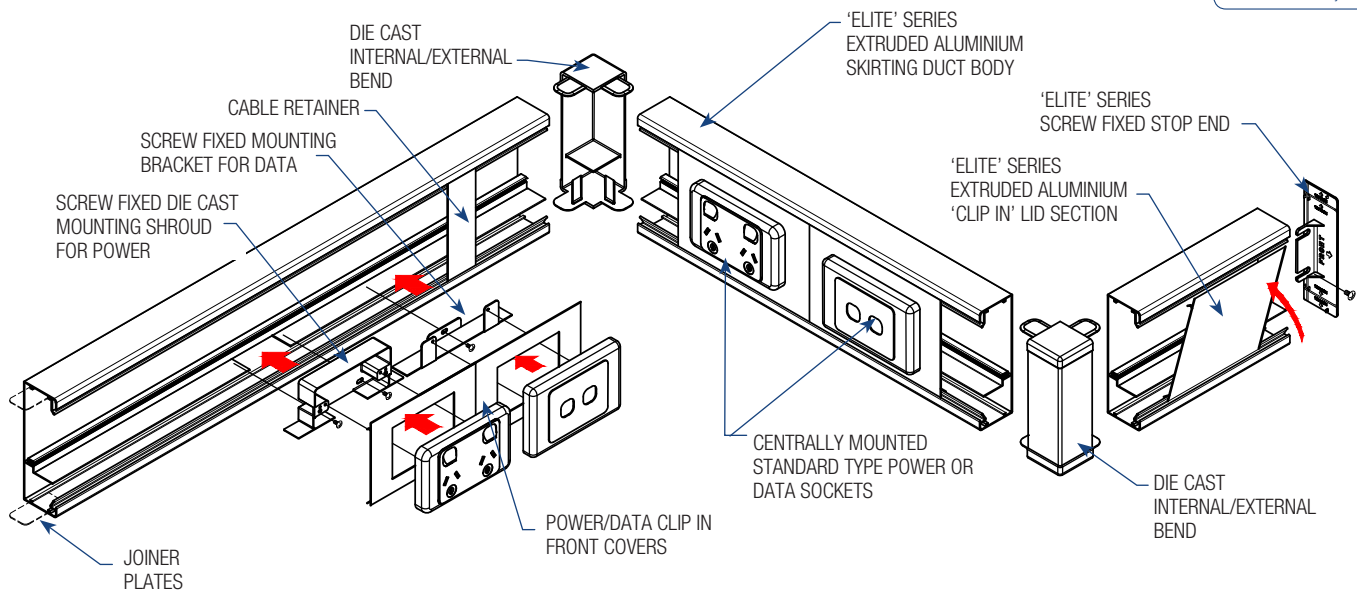

SUGGESTED SPECIFICATION

- The contractor shall allow to supply and install Electric Cable Duct Systems P/L ECD® 'ELITE SERIES' Cat No. EL20050C skirting duct and cover (200x50mm) surface mounted or as otherwise nominated.
- The body of the duct and cover shall be extruded aluminium pre-treated and powdercoated to a standard colour (White, APO Grey, Black or Natural Anodised) or as nominated by the architect.
- The system shall be earthed in accordance with AS 3000 wiring rules and conform to A.C.M.A. requirements.
- The internal/external corners shall be fitted with die-cast bends or site mitred.
- Adjacent lengths of duct body shall be splice joined with slide in joiner plates and earth continuity plates.
- Stop ends shall be fitted where necessary.
- GPOs shall be mounted to the duct body using GPO mounting kits including die-cast shroud, earth wire and punched front cover. Power circuits within the duct shall be double insulated cable.
- Data outlets shall be mounted to the duct body using data mounting kits including data bracket and punched front cover.

PARTS LIST

| DESCRIPTION | PART NO. | COLOUR |
|--|-----------|----------------------|
| Duct body and Clip-in cover (3m lengths) incl. joining kit | EL20050CD | Nominate (see below) |
| Internal/External Bend (Die-cast) | EL20050B | Nominate (see below) |
| Stop End | EL200SE | Nominate (see below) |
| GPO Kit (Clip In) c/w die-cast power shroud | EL200CPK | Nominate (see below) |
| Data Kit (Clip In) c/w data bracket | EL200CDK | Nominate (see below) |
| Flat Bend Joiner | ELFBJ | |
| Cat 6A Angled Data Face Plate | 88DP2 | Nominate (see below) |
| Divider (optional) for 3 division | EL50DB | |
| Bend Radius | EL200BR | |

Nominate Colour/Finish: BK=Black, WE=White, GY=Apo Grey, NA=Natural Anodised

CABLE CAPACITY CHART (ALLOWS FOR 60% AIR SPACE)

| POWER CABLES | | DATA CABLES | | |
|---------------------|---------------------|-------------|--------|---------|
| 2.5 mm ² | 4.0 mm ² | Cat. 5E | Cat. 6 | Cat. 6A |
| 24 | 12 | 85 | 50 | 32 |